

# CeraVent®

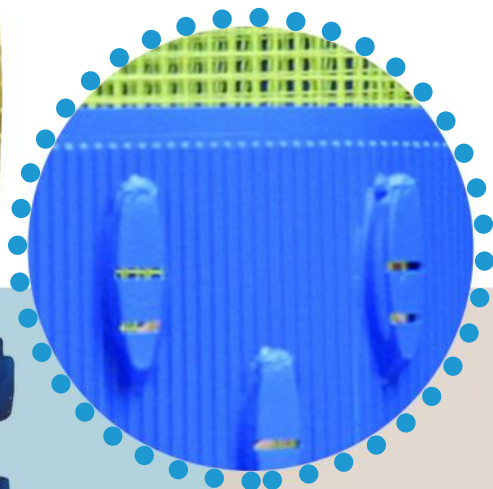

1. anchorable wall structure
2. stone wool
3. X7G adhesive
4. CeraVent® drainage vertical facade layer
5. CeraVent® wall plug set comprising screw plugs, screws, wall plug plate and cover
6. ARDEX X 32 adhesive
7. mesh CeraVent®
8. ARDEX X 32 adhesive reinforced with ARDEX E 90
9. facade ceramic panel



Ventilation of the facade/wall through the covering support mat.



Discharges diffused water vapour, preventing frost damage and efflorescence.



Secured simply by the wall plug system, it is suitable for many different uses, e.g. on substrates with problem adhesions such as paint or damp layers of plaster.



Avoids the formation of cracks due to critical shear stresses.



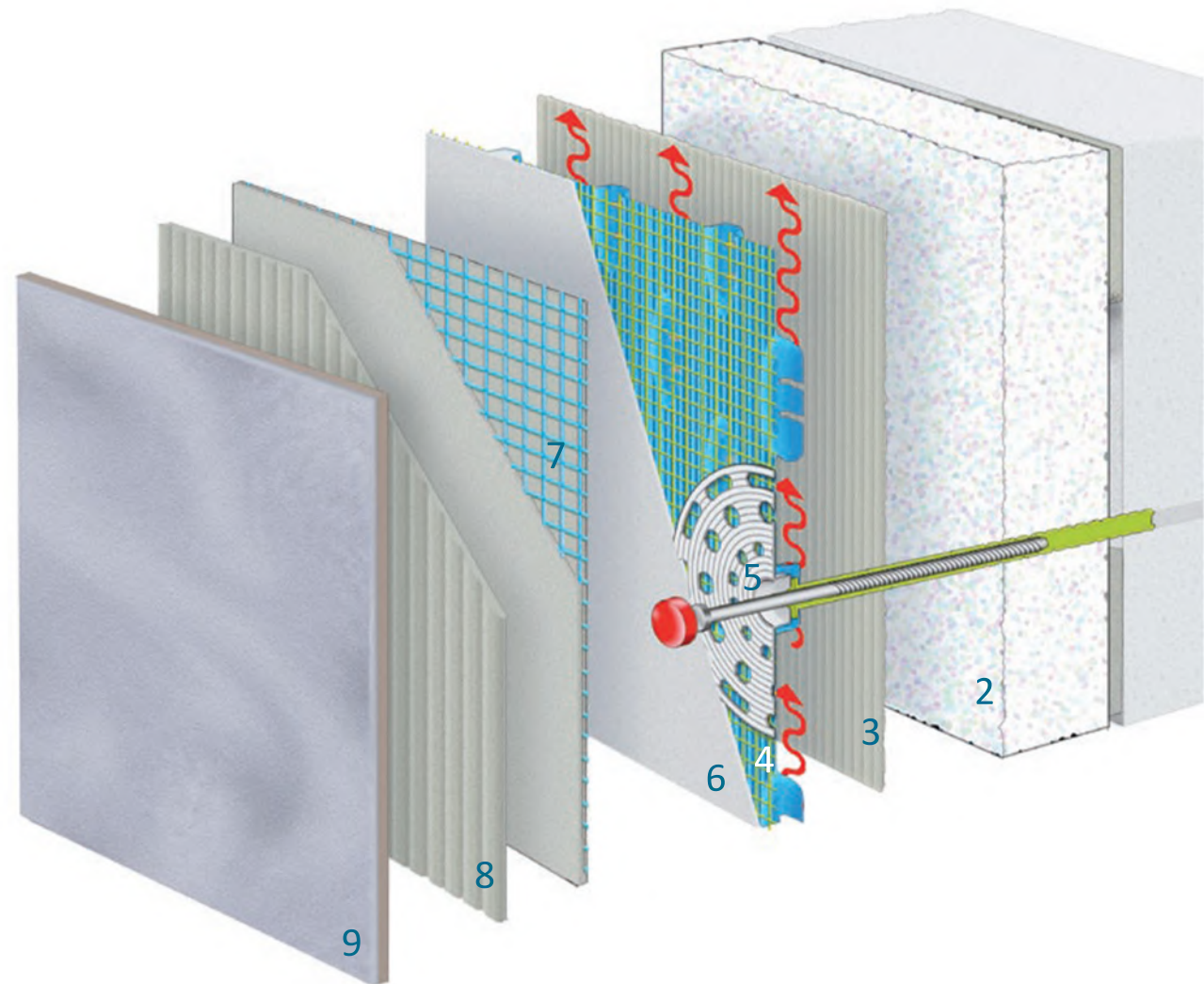
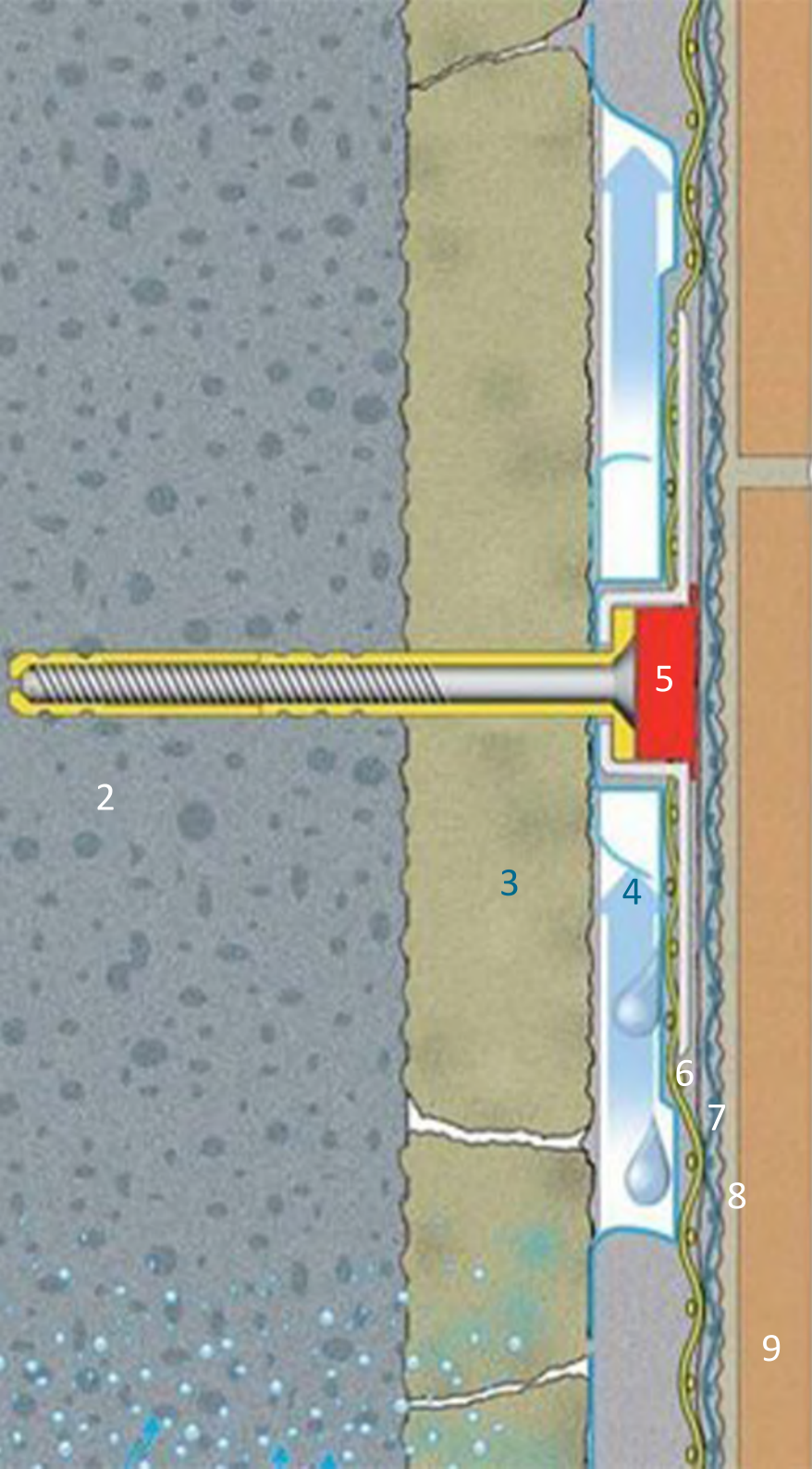

1. anchorable wall structure
2. stone wool
3. X7G adhesive
4. CeraVent® drainage vertical facade layer
5. CeraVent® wall plug set comprising screw plugs, screws, wall plug plate and cover
6. ARDEX X 32 adhesive
7. mesh CeraVent®
8. ARDEX X 32 adhesive reinforced with ARDEX E 90
9. facade ceramic panel